

features and benefits:

- Heavy-duty 50mm curved aluminum tube frame with heavy duty internal spigots
- Connects four C-shaped structures to form an organic, elegant floral shape
- Fits ideally in a large island space
- Kit includes: one frame, one dye-sublimated zipper pillowcase graphic, four wheeled molded OCE cases
- Lifetime hardware warranty against manufacturer defects

dimensions:

Hardware	Graphic
<p>Assembled unit: 329" w x 136.5" h x 329" d 8357mm(w) x 3467mm(h) x 8357mm(d)</p> <p>Each C Curve: 92" w x 68.56" r 2337mm(w) x 1741mm(r)</p> <p>Approximate weight (includes graphic): 296.5 lbs / 135 kg</p>	<p>Total visual area: Outside: 92" w x 271.6" h 2337mm(w) x 6899mm(h)</p> <p>Inside: 92" w x 263" h 2337mm(w) x 5994mm(h)</p> <p>Eight prints create one structure. Please be sure to include the 5" bleed around the perimeter.</p>
<p>Shipping</p> <p>Shipping dimensions - ships in four cases: 4 OCE cases: 18" l x 18" w x 40" h up to 60" h 457mm(l) x 457mm(w) x 1016mm(h) up to 1675mm(h)</p> <p>Approximate shipping weight (with cases): 380.5 lbs / 172.6 kg</p>	

additional information:

Graphic material:
Dye-sublimated zipper pillowcase fabric

Parts Included		
Part Label	Qty	Part Code
EXPANDING SPIGOT FOR 30MM TUBE	x36	ES-30
EXPANDING SPIGOT FOR 50MM TUBE	x52	ES-50
1194MM X 50MM CORNER SECTION	x8	RM-T1
R1710MM X 50" CURVED TUBE SECTION	x8	RM-T2
R1710MM X 50" CURVED TUBE SECTION WITH 30MM SPREADER LEFT SIDE	x12	RM-T2-SP30-L
R1710MM X 50" CURVED TUBE SECTION WITH 30MM SPREADER RIGHT SIDE	x12	RM-T2-SP30-R
1048MM X 50MM SECTION	x24	RM-T3
1016MM X 50MM SECTION	x8	RM-T4
FLOWER FABRIC GRAPHIC (FOUR C-SHAPED GRAPHICS)	x1	FLOWER-RM-G

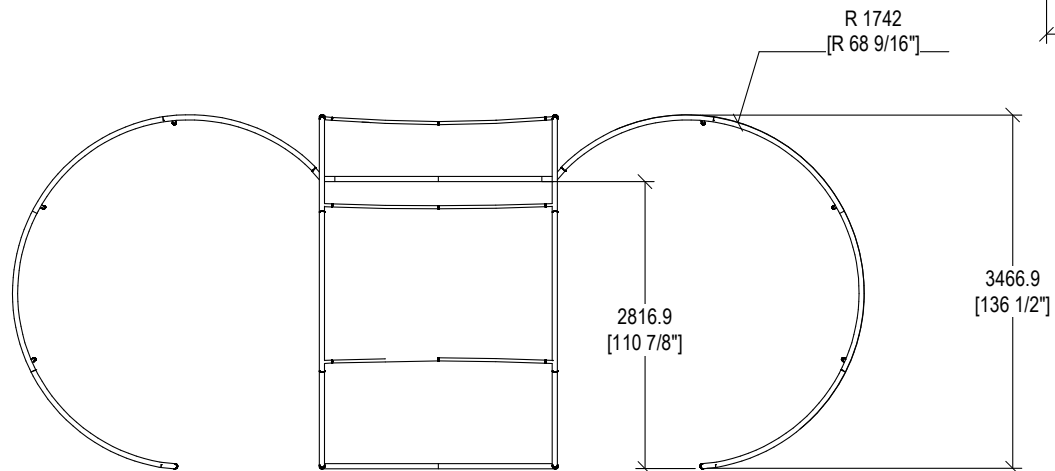
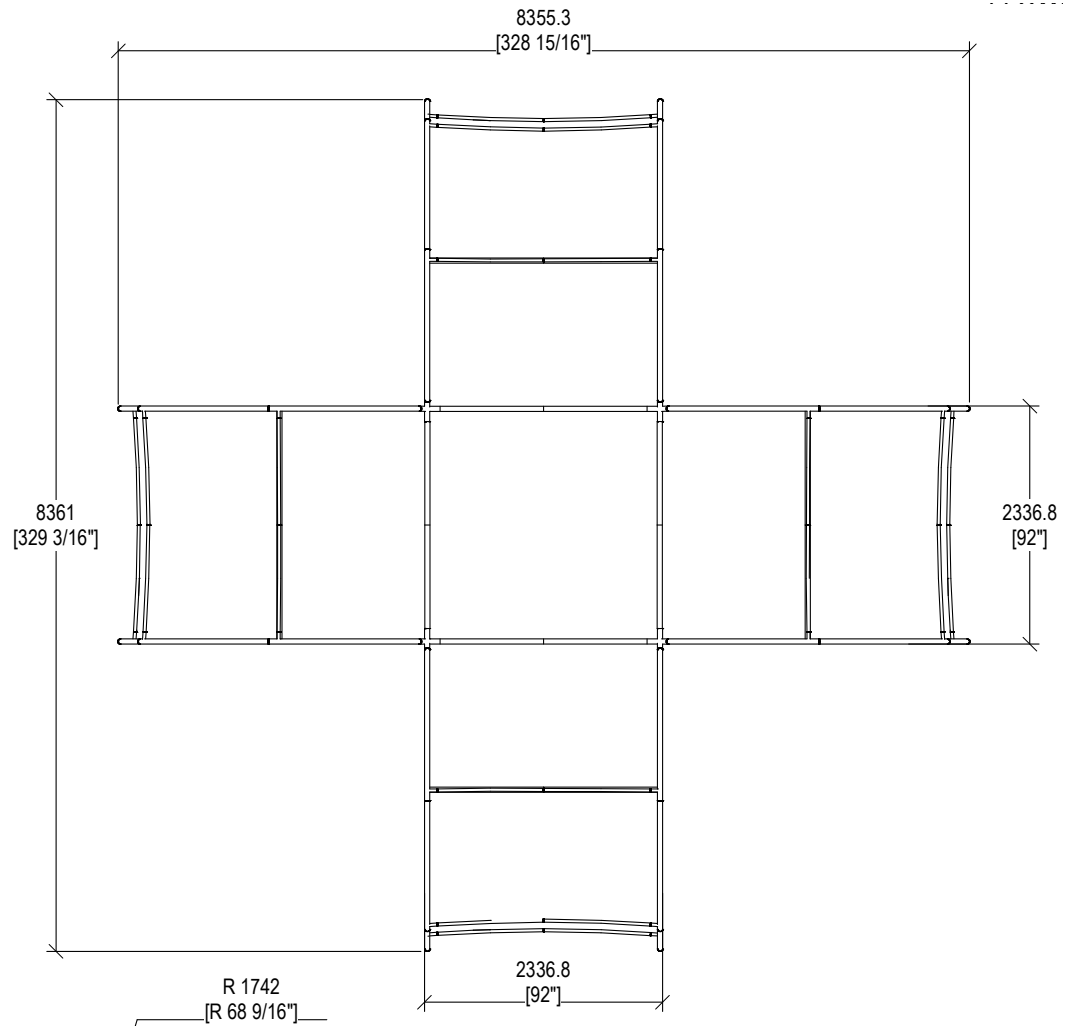

FLOWER PARTS EXPLODED:

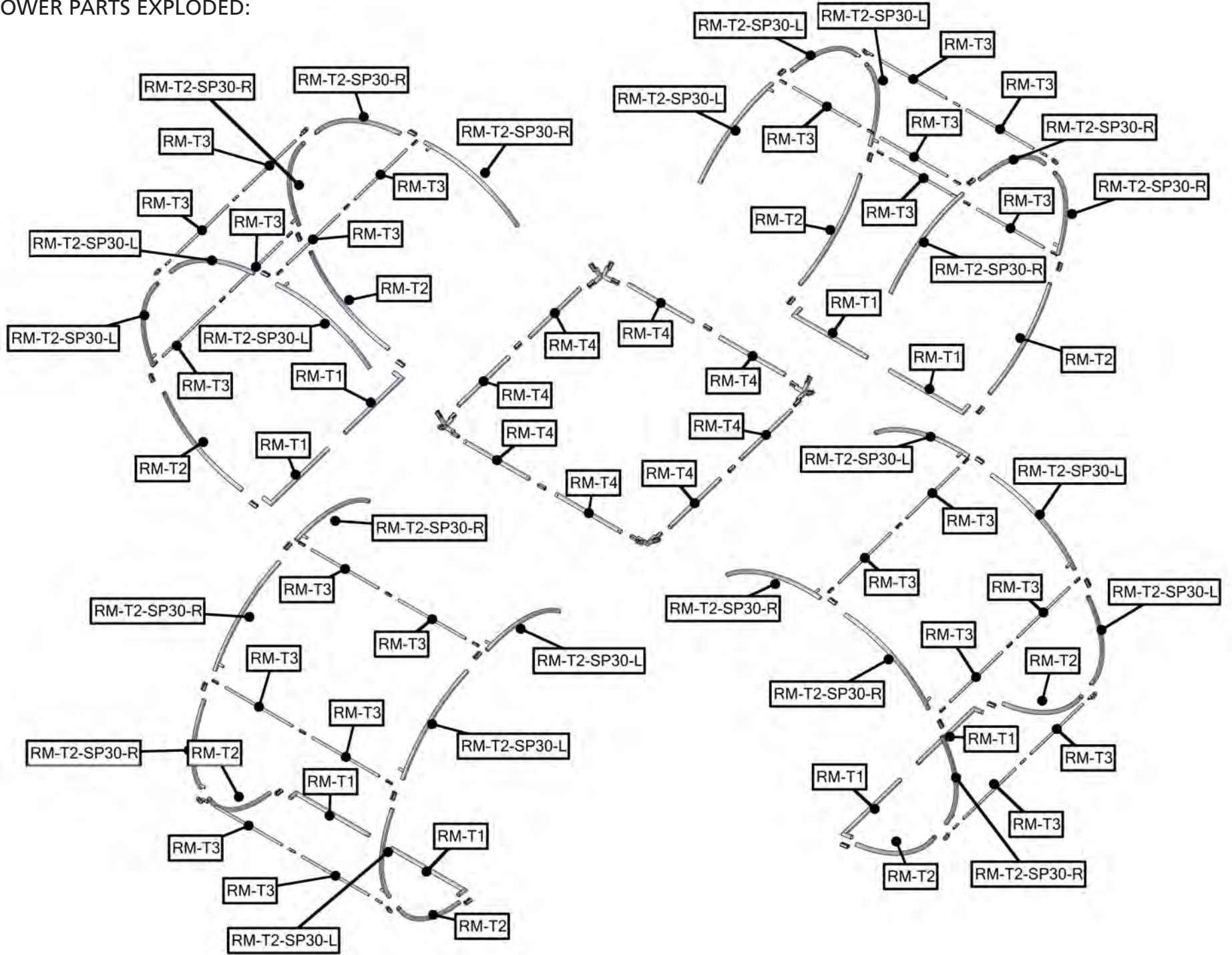

FLOWER FRAME ASSEMBLY:

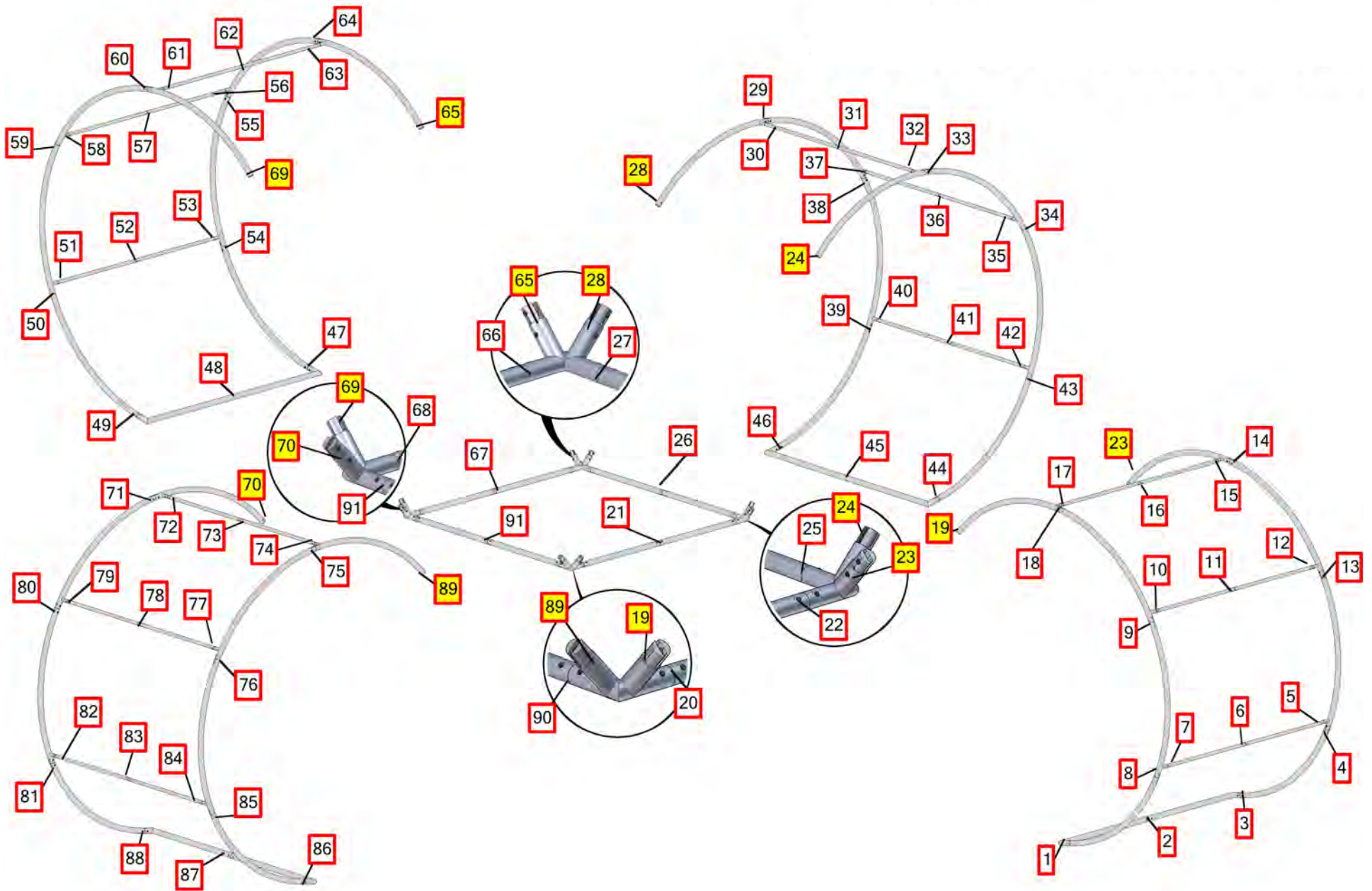

Flower Section 1

Frame Assembly:

Assemble unit by laying tubes flat on the floor. Connect the tube rails following the labels by matching number to number. See detailed drawing.

Slide joiner into tubing so hex screw sits in hole on tube. Tighten the hex screw so the joiner separates and tightens against the inside of the tubing, locking the joiner and tubing together.

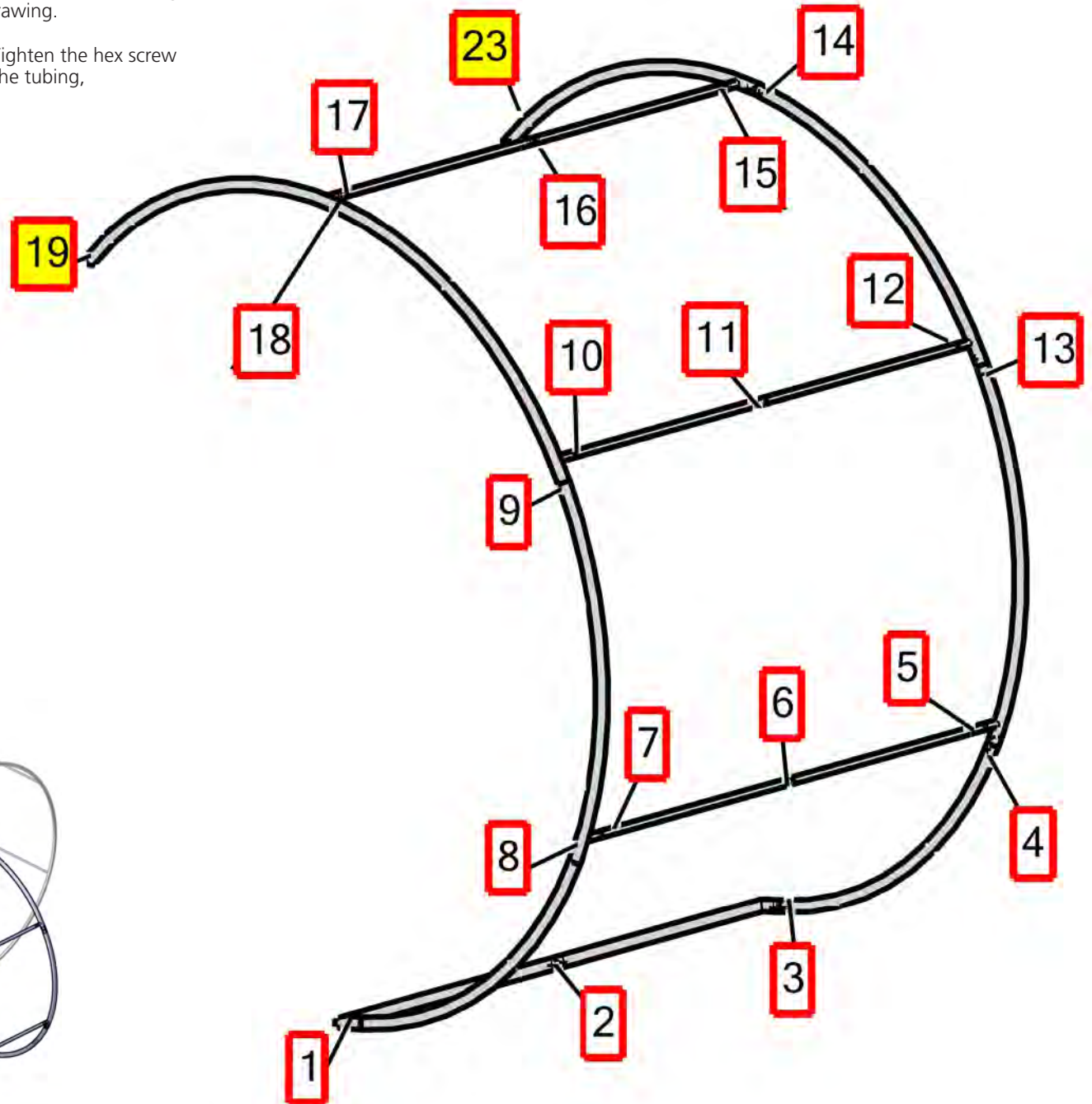
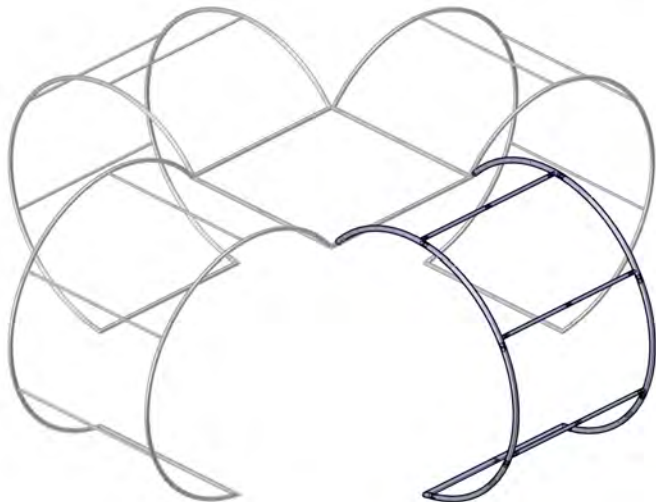
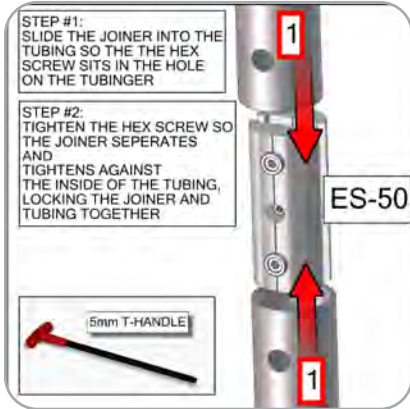

Flower Section 2

Frame Assembly:

Assemble unit by laying tubes flat on the floor. Connect the tube rails following the labels by matching number to number. See detailed drawing.

Slide joiner into tubing so hex screw sits in hole on tube. Tighten the hex screw so the joiner separates and tightens against the inside of the tubing, locking the joiner and tubing together.

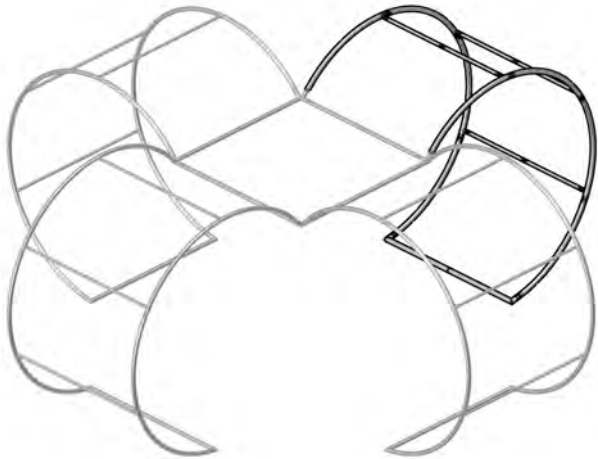
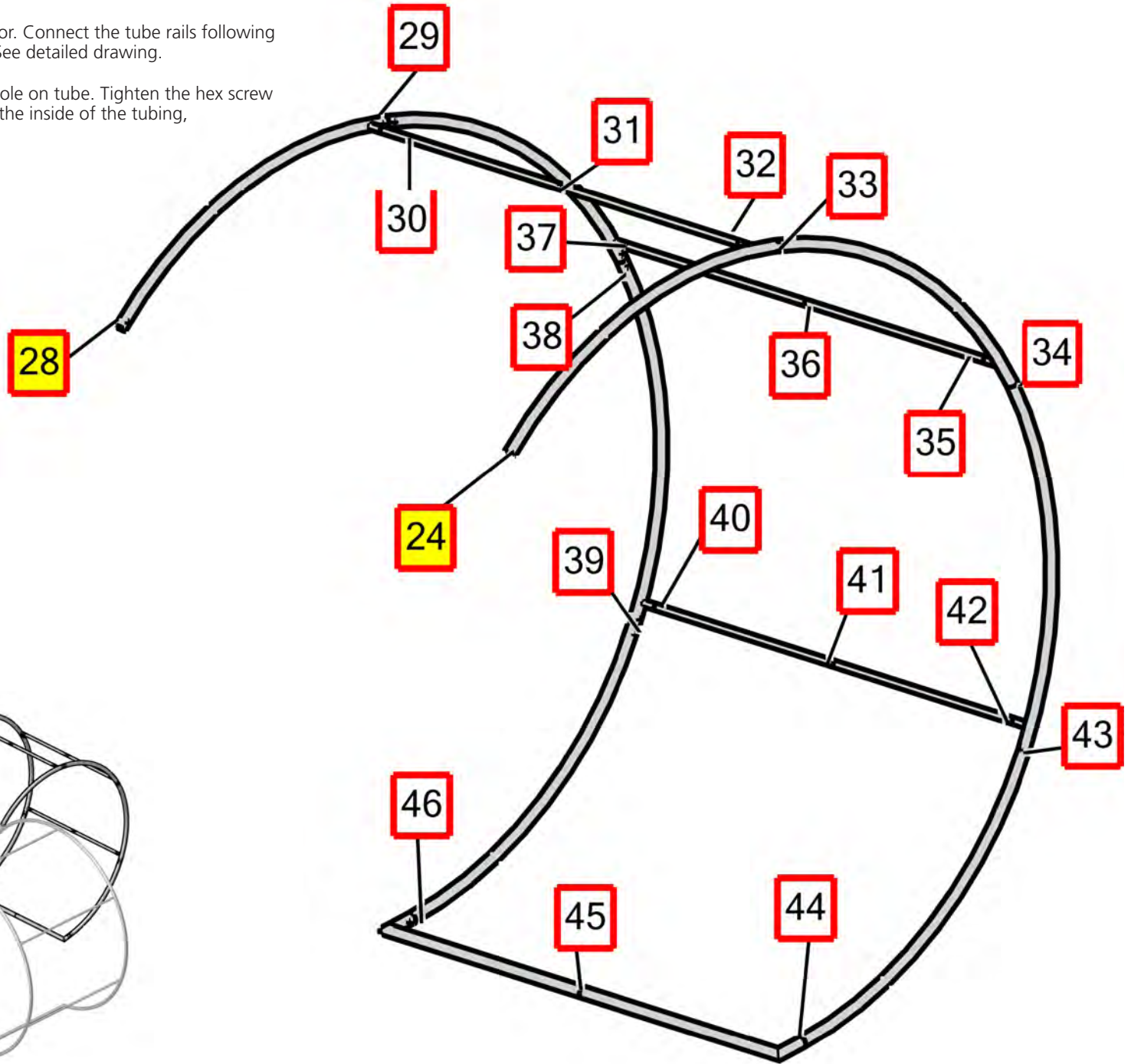
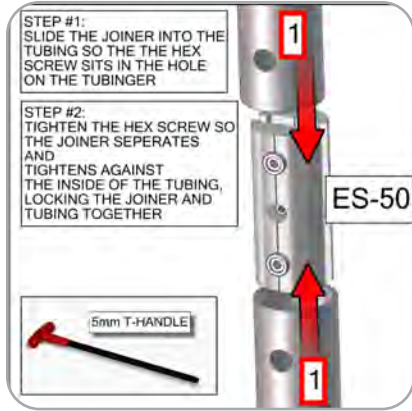

Flower Section 3

Frame Assembly:

Assemble unit by laying tubes flat on the floor. Connect the tube rails following the labels by matching number to number. See detailed drawing.

Slide joiner into tubing so hex screw sits in hole on tube. Tighten the hex screw so the joiner separates and tightens against the inside of the tubing, locking the joiner and tubing together.

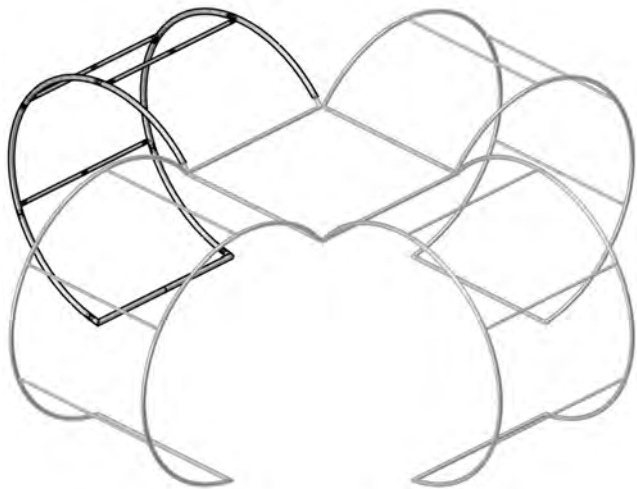
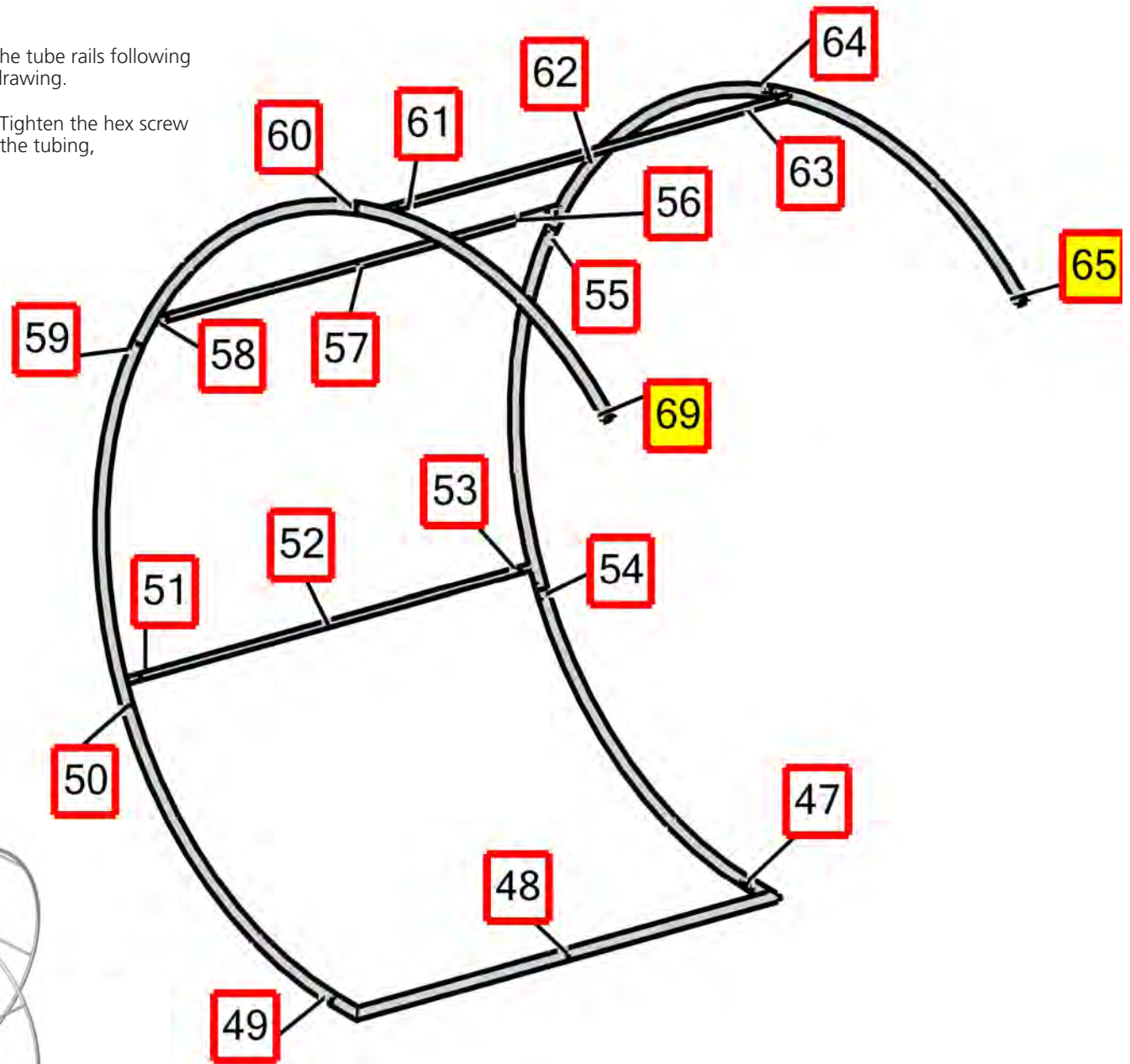
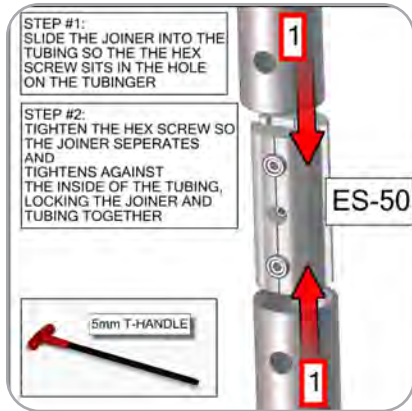

Flower Section 4

Frame Assembly:

Assemble unit by laying tubes flat on the floor. Connect the tube rails following the labels by matching number to number. See detailed drawing below.

Slide joiner into tubing so hex screw sits in hole on tube. Tighten the hex screw so the joiner separates and tightens against the inside of the tubing, locking the joiner and tubing together.

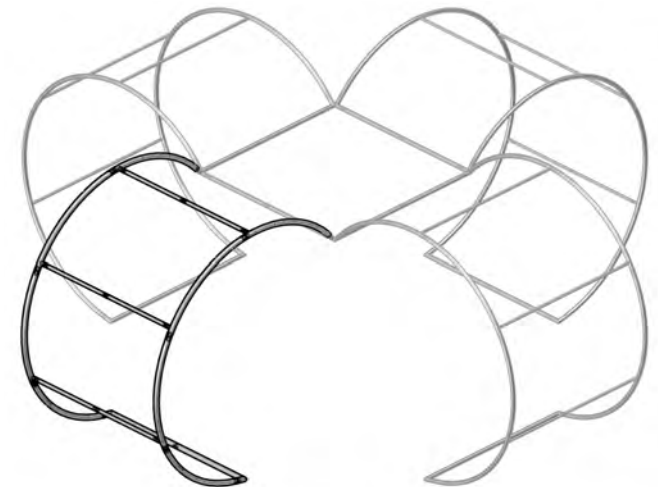
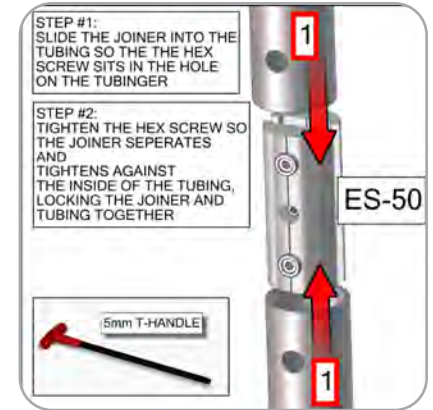
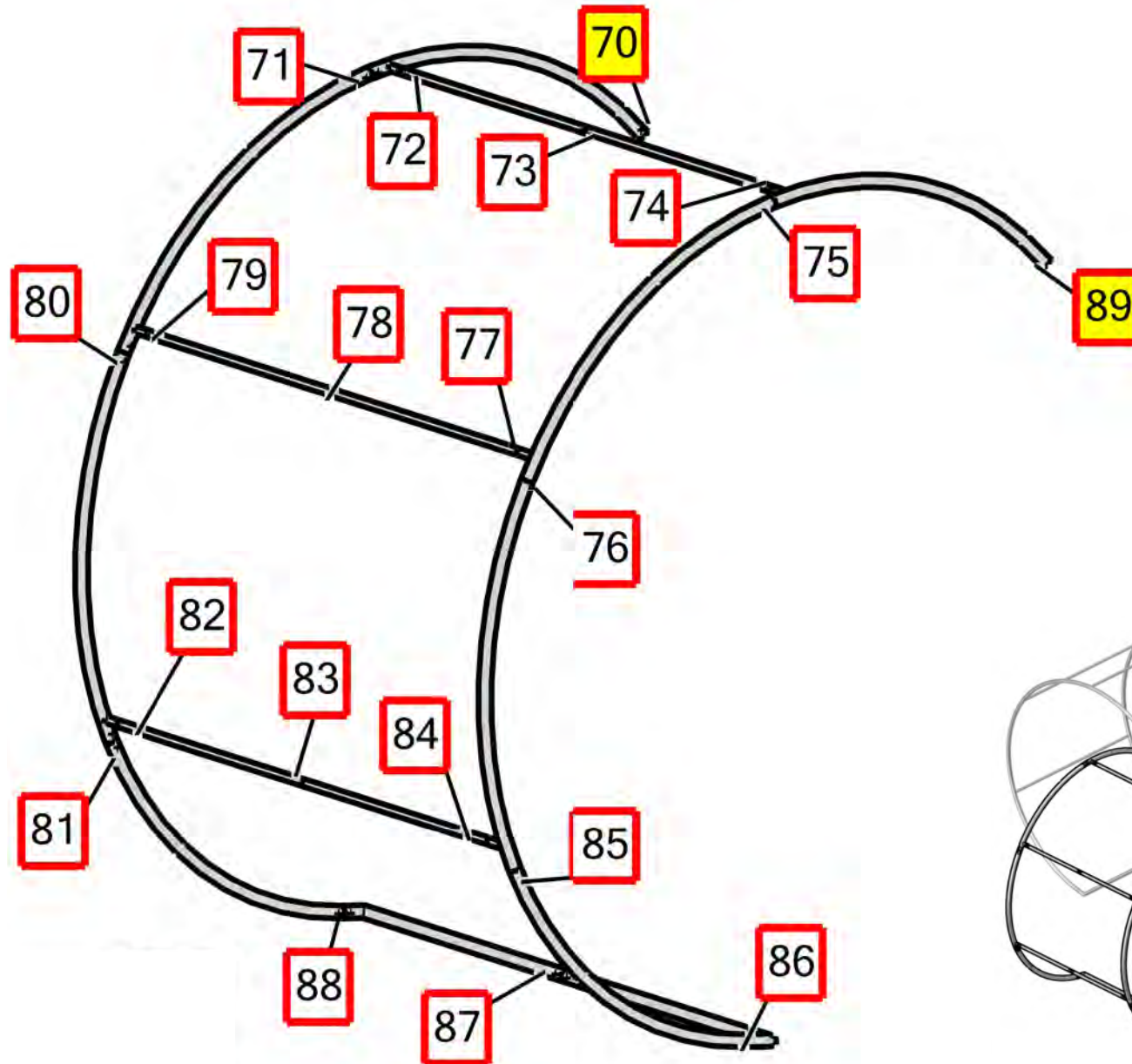

Flower Section 5

Frame Assembly:

Assemble unit by laying tubes flat on the floor. Connect the tube rails following the labels by matching number to number. See detailed drawing.

Slide joiner into tubing so hex screw sits in hole on tube. Tighten the hex screw so the joiner separates and tightens against the inside of the tubing, locking the joiner and tubing together.

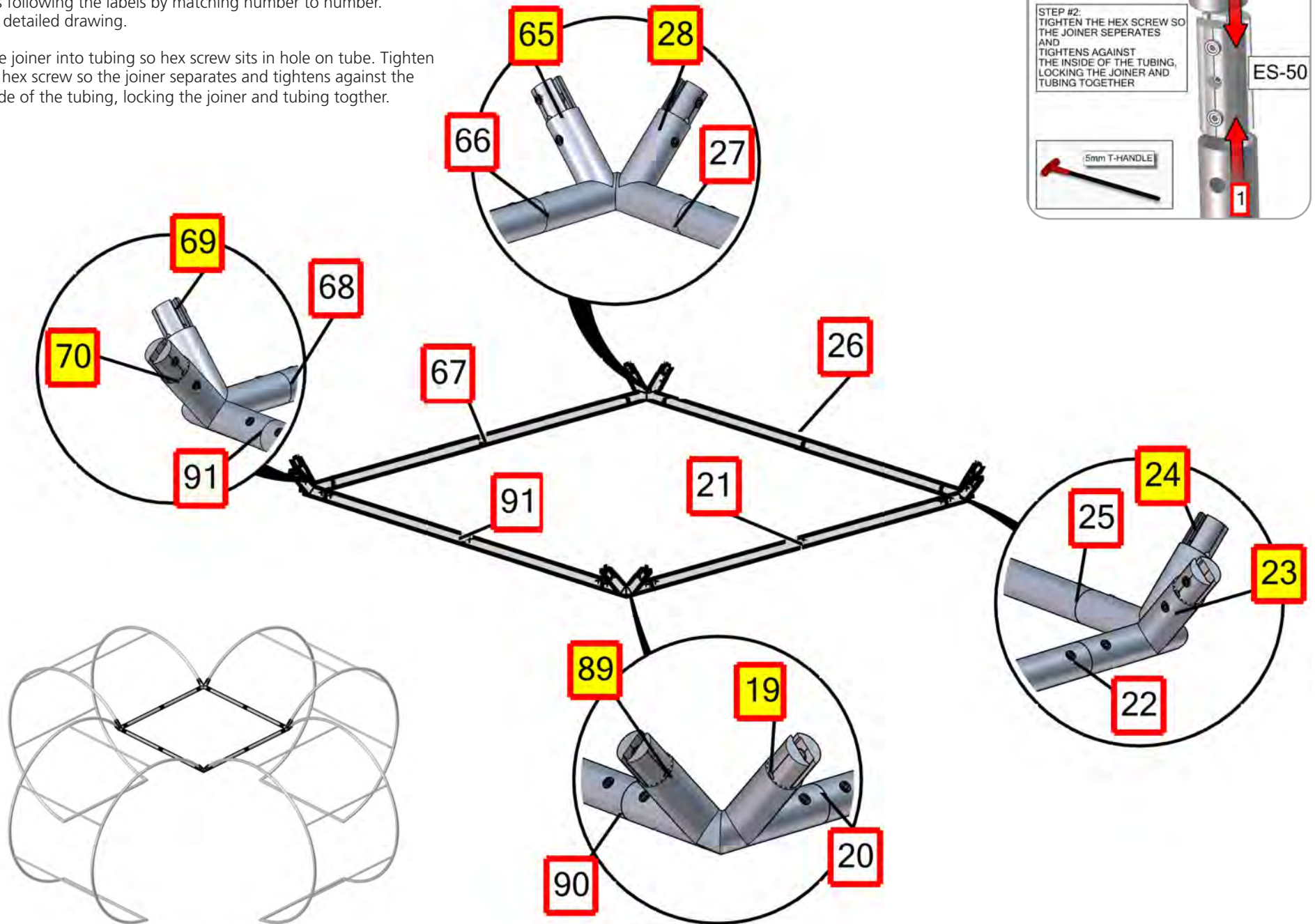

STEP 1: ASSEMBLE FRAME

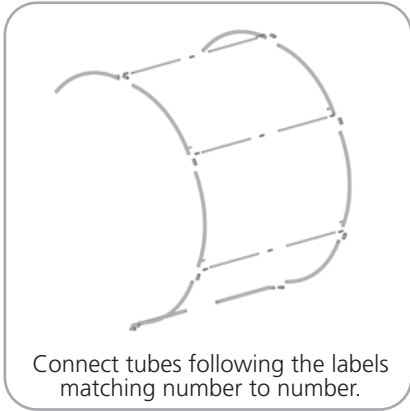

Connect tubes following the labels matching number to number.

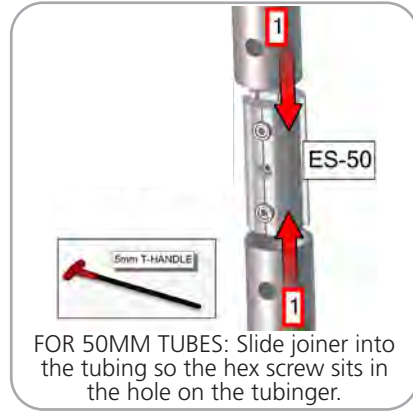

FOR 50MM TUBES: Slide joiner into the tubing so the hex screw sits in the hole on the tubinger.

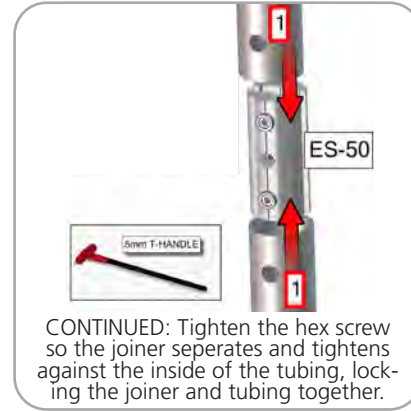

CONTINUED: Tighten the hex screw so the joiner separates and tightens against the inside of the tubing, locking the joiner and tubing together.

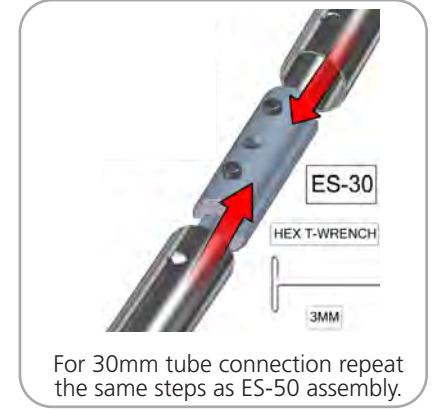

For 30mm tube connection repeat the same steps as ES-50 assembly.

STEP 2: ATTACH GRAPHICS

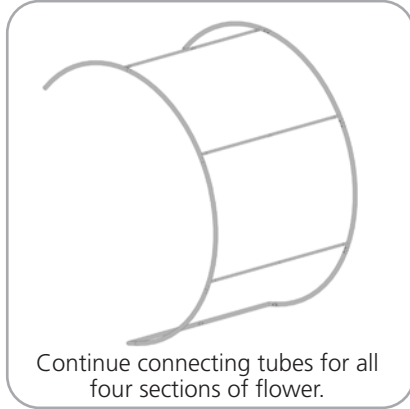

Continue connecting tubes for all four sections of flower.

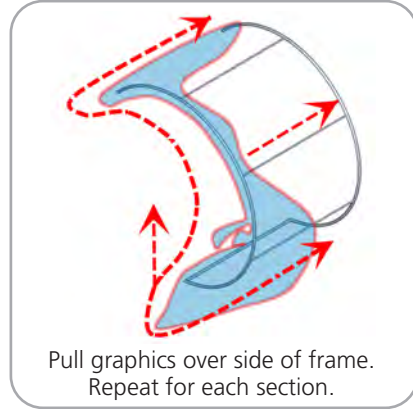

Pull graphics over side of frame. Repeat for each section.

STEP 4: ZIP GRAPHICS

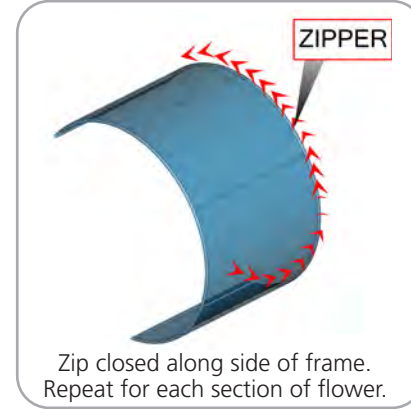

Zip closed along side of frame. Repeat for each section of flower.

STEP 5: ASSEMBLE FRAME

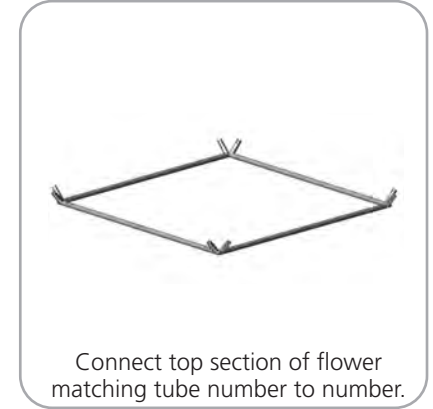

Connect top section of flower matching tube number to number.

STEP 5: ATTACH SECTION CORNERS TO TOP FRAME

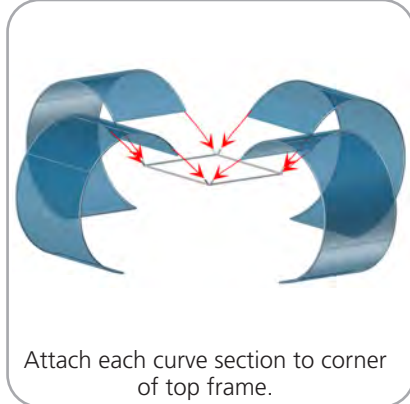

Attach each curve section to corner of top frame.

STEP 6: ZIP GRAPHICS

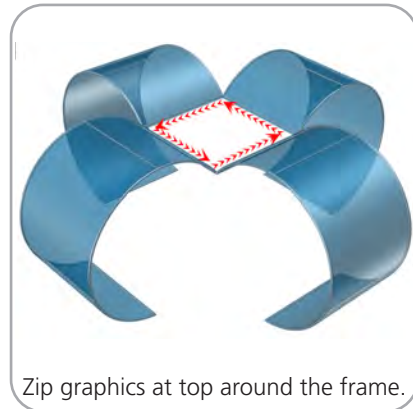

Zip graphics at top around the frame.